

Application to the HISTORIC DISTRICT COMMISSION, Nantucket, Massachusetts, for a

CERTIFICATE OF APPROPRIATENESS

for structural work.

All blanks must be filled in using BLUE OR BLACK INK (no pencil) or marked N/A.

NOTE: It is strongly recommended that the applicant be familiar with the HDC guidelines, *Building with Nantucket in Mind*, prior to submittal of application. Please see other side for submittal requirements. Incomplete applications will not be reviewed by the HDC.

This is a contractual agreement and must be filled out in ink. An application is hereby made for issuance of a Certificate of Appropriateness under Chapter 395 of the Acts and Resolves of Mass., 1970, for proposed work as described herein and on plans, drawings and photographs accompanying this application and made a part hereof by reference.

The certificate is valid for three years from date of issuance. No structure may differ from the approved application. Violation may impede issuance of Certificate of Occupancy.

PROPERTY DESCRIPTION

TAX MAP N°: 68 PARCEL N°: 337
Street & Number of Proposed Work: 2 ORCHID PLACE
Owner of record: RICHMOND MEADOWS TWO ACK, LLC
Mailing Address: 23 CONCORD STREET
WILMINGTON, MA 01887
Contact Phone #: 978-815-4832 E-mail: ppaxstan@richmondca.com

AGENT INFORMATION (If applicable)

Name: Dinah Klameret, KKH ARCHITECTURE, PLLC
Mailing Address: 87-10 NORTHERN BLVD. SUITE 204
JACKSON HEIGHTS, NY 11372
Contact Phone #: 718-225-6400 E-mail: clinahk@koharch.com

FOR OFFICE USE ONLY

Date application received: _____ Fee Paid: \$ _____

Must be acted on by: _____

Extended to: _____

Approved: _____ Disapproved: _____

Chairman: _____

Member: _____

Member: _____

Member: _____

Member: _____

Member: _____

Notes - Comments - Restrictions - Conditions

DESCRIPTION OF WORK TO BE PERFORMED

See reverse for required documentation.

- New Dwelling Addition Garage Driveway/Apron Commercial Historical Renovation Deck/Patio Steps Shed
 - Color Change Fence Gate Hardscaping Move Building Demolition Revisions to previous Cert. No. _____
 - Pool (Zoning District _____) Roof Other site guardrail and handrail
- Size of Structure or Addition: Length: _____ Sq. Footage 1st floor: _____ Decks/Patio: Size: _____ 1st floor 2nd floor
Width: _____ Sq. Footage 2nd floor: _____ Size: _____ 1st floor 2nd floor
Sq. Footage 3rd floor: _____

Difference between existing grade and proposed finish grade: North _____ South _____ East _____ West _____
Height of ridge above final finish grade: North _____ South _____ East _____ West _____

Additional Remarks

Historic Name: _____

Original Date: _____

Original Builder: _____

Is there an HDC survey form for this building attached? Yes N/A

REVISIONS*

1. East Elevation
2. South Elevation
3. West Elevation
4. North Elevation

*Cloud on drawings and submit photographs of existing elevations.

DETAIL OF WORK TO BE PERFORMED

Foundation: Height Exposed _____ Block Block Parged Brick (type) _____ Poured Concrete Piers

Masonry Chimney: Block Parged Brick (type) _____ Other _____

Roof Pitch: Main Mass _____/12 Secondary Mass _____/12 Dormer _____/12 Other _____

Roofing material: Asphalt: 3-Tab Architectural
 Wood (Type: Red Cedar, White Cedar, Shakes, etc.) _____

Fence: Height: 3'-6"
Type: site guard rail + handrail
Length: 12' 11"

Skylights (flat only): Manufacturer _____ Rough Opening _____ Size _____ Location _____
Manufacturer _____ Rough Opening _____ Size _____ Location _____

Gutters: Wood Aluminum Copper Leaders (material) _____

Leaders (material and size): _____

Sidewall: White cedar shingles _____ Clapboard (exposure: _____ inches) Front Side
 Other _____

Trim: A. Wood Pine Redwood Cedar Other _____

B. Treatment Paint Natural to weather Other _____

C. Dimensions: Fascia _____ Rake _____ Soffit (Overhang) _____ Corner boards _____ Frieze _____

Window Casing _____ Door Frame _____ Columns/Posts: Round _____ Square _____

Windows*: Double Hung Casement All Wood Other _____

True Divided Lights (muntins), single pane SDL's (Simulated Divided Lights) Manufacturer _____

Doors* (type and material): TDL SDL Front _____ Rear _____ Side _____

Garage Door(s): Type _____ Material _____

Hardscape materials: Driveways _____ Walkways _____ Walks _____

* Note: Complete door and window schedules are required.

COLORS

Sidewall _____ Clapboard (if applicable) _____ Roof _____

Trim _____ Sash _____ Doors _____

Deck _____ Foundation _____ Fence Black Shutters _____

* Attach manufacturer's color samples if color is not from HDC approval list.

(powder-coated aluminum)

I hereby authorize the agent named above to act on my behalf to make changes in the specifications or the plans contained in this application in order to bring the application into compliance with the HDC guidelines. I hereby agree to abide by and comply with the terms and conditions of this application. I hereby agree that the submission of any revisions to this application will initiate a new sixty-day review period.

Date 2/5/2020

Signature of owner of record _____

Signed under penalties of perjury

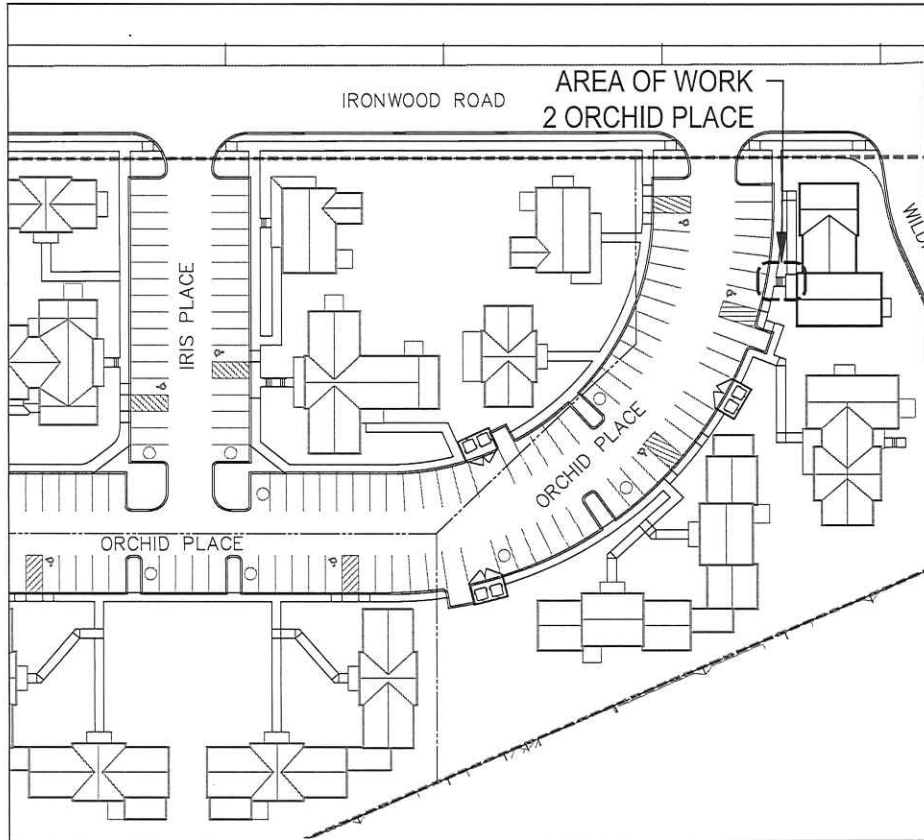

1 SITE PLAN - 2 ORCHID PLACE
SCALE: NTS



'DuraLife Nantucket' ALUMINUM RAILING
SCALE: NTS



'DuraLife' FINISH OPTIONS
SCALE: NTS

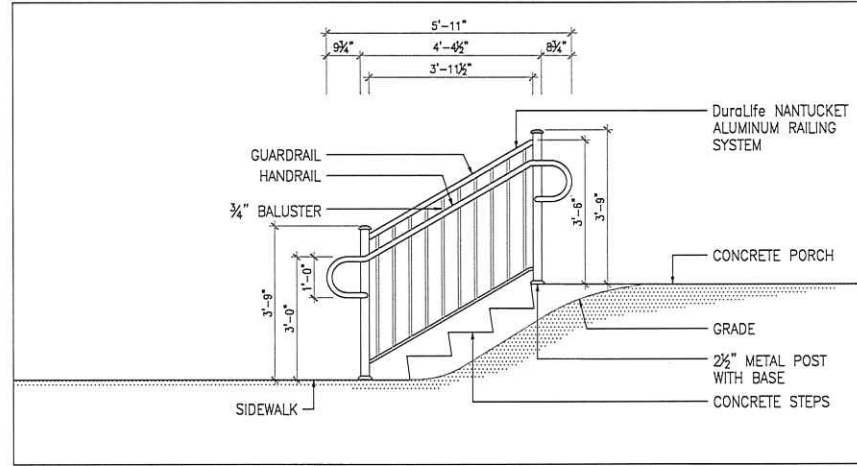

2 EXTERIOR RAILING ELEVATION - 2 ORCHID PLACE
SCALE: 3/4" = 1'-0"

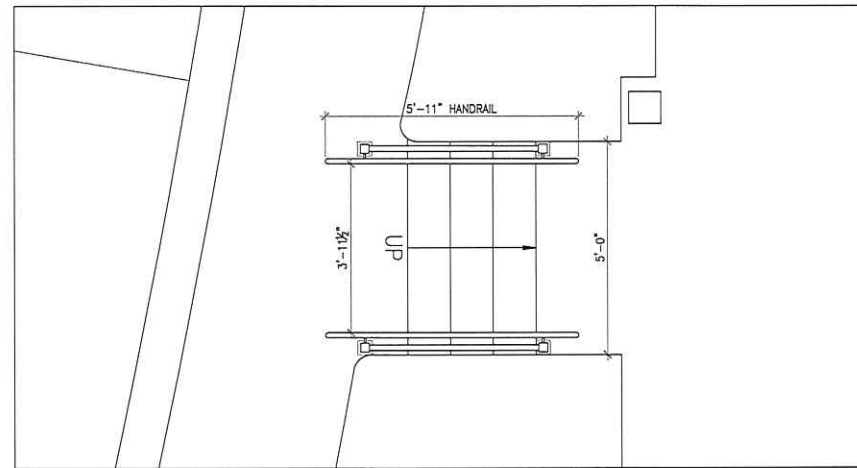

3 EXTERIOR RAILING PLAN - 2 ORCHID PLACE
SCALE: 3/4" = 1'-0"

OWNER :

Richmond Great Point Development, LLC
23 Concord Street, Wilmington, MA 01887

ARCHITECT OF RECORD :

KOH ARCHITECTURE PLLC

45-14 251st STREET, SUITE 101
LITTLE NECK, NY 11362
(718) 223-6400 phone
(718) 223-6404 fax
Dinah Kamert, RA

CONCRETE PORCH

GRADE

2 1/2" METAL POST WITH BASE

CONCRETE STEPS

NOTED:
ALL WORK SHALL COMPLY WITH LOCAL, MUNICIPAL, AND STATE CODES, ORDINANCES, ETC.

BY: JT DATE: 08/01/2017
JOB NO. 2009-144
REVIEWED: DK SCALE: AS NOTED

CERTIFICATION AND SEAL

I HEREBY CERTIFY THAT THIS PLAN AND SPECIFICATION WAS PREPARED BY ME OR UNDER MY SUPERVISION AND THAT I AM A duly REGISTERED ARCHITECT OR ENGINEER UNDER THE LAWS OF THE STATE OF MASSACHUSETTS AS SET FORTH BY ME AND SEAL.

PROJECT NAME

MEADOWS 2 APARTMENTS

ADDRESS

MAP: 68 PARCEL: 336
2 ORCHID PLACE
NANTUCKET, MA

DRAWING TITLE

RAILING HARDSCAPE PLAN

DRAWING NO.

A-1

