

Application to the HISTORIC DISTRICT COMMISSION, Nantucket, Massachusetts, for a

CERTIFICATE OF APPROPRIATENESS

for structural work.

All blanks must be filled in using BLUE OR BLACK INK (no pencil) or marked N/A.
NOTE: It is strongly recommended that the applicant be familiar with the HDC guidelines, *Building with Nantucket in Mind*, prior to submittal of application. Please see other side for submittal requirements. Incomplete applications will not be reviewed by the HDC.

This is a contractual agreement and must be filled out in ink. An application is hereby made for issuance of a Certificate of Appropriateness under Chapter 395 of the Acts and Resolves of Mass., 1970, for proposed work as described herein and on plans, drawings and photographs accompanying this application and made a part hereof by reference.

The certificate is valid for three years from date of issuance. No structure may differ from the approved application. Violation may impede issuance of Certificate of Occupancy.

PROPERTY DESCRIPTION

TAX MAP N°: 68 PARCEL N°: 336
Street & Number of Proposed Work: 4 IRIS Place
Owner of record: Richmond Meadows TWO ACK, LLC
Mailing Address: 23 Concord Street
Wilmington, MA 01887
Contact Phone #: 978-815-4832 E-mail: ppastan@richmondco.com

AGENT INFORMATION (if applicable)

Name: Dinah Klarnet, KOH Architecture, PLLC
Mailing Address: 87-10 Northern Blvd. Suite 204
Jackson Heights, NY 11372
Contact Phone #: 718-225-6400 E-mail: dinah@koharch.com

FOR OFFICE USE ONLY

Date application received: _____ Fee Paid: \$ _____
Must be acted on by: _____
Extended to: _____
Approved: _____ Disapproved: _____
Chairman: _____
Member: _____
Member: _____
Member: _____
Member: _____
Member: _____
Notes - Comments - Restrictions - Conditions

DESCRIPTION OF WORK TO BE PERFORMED

See reverse for required documentation.

New Dwelling Addition Garage Driveway/Apron Commercial Historical Renovation Deck/Patio Steps Shed
 Color Change Fence Gate Hardscaping Move Building Demolition Revisions to previous Cert. No. _____
 Pool (Zoning District _____) Roof Other: site guard rail + handrail
Size of Structure or Addition: Length: _____ Sq. Footage 1st floor: _____ Decks/Patio: Size: _____ 1st floor 2nd floor
Width: _____ Sq. Footage 2nd floor: _____ Size: _____ 1st floor 2nd floor
Sq. Footage 3rd floor: _____

Difference between existing grade and proposed finish grade: North _____ South _____ East _____ West _____
Height of ridge above final finish grade: North _____ South _____ East _____ West _____

Additional Remarks

Historic Name: _____
Original Date: _____ (describe)
Original Builder: _____
Is there an HDC survey form for this building attached? Yes N/A

REVISIONS:

1. East Elevation
2. South Elevation
3. West Elevation
4. North Elevation

*Cloud on drawings and submit photographs of existing elevations.

DETAIL OF WORK TO BE PERFORMED

Foundation: Height Exposed _____ Block Block Parged Brick (type) _____ Poured Concrete Piers _____
Masonry Chimney: Block Parged Brick (type) _____ Other _____
Roof Pitch: Main Mass _____/12 Secondary Mass _____/12 Dormer _____/12 Other _____
Roofing material: Asphalt: 3-Tab Architectural
 Wood (Type: Red Cedar, White Cedar, Shakes, etc.) _____

Fence: Height: 3'-6"
Type: site guard rail + handrail
Length: 122 11"

Skylights (flat only): Manufacturer _____ Rough Opening _____ Size _____ Location _____
Manufacturer _____ Rough Opening _____ Size _____ Location _____

Gutters: Wood Aluminum Copper Leaders (material) _____

Leaders (material and size):

Sidewall: White cedar shingles _____ Clapboard (exposure: _____ inches) Front Side
 Other _____

Trim: A. Wood Pine Redwood Cedar Other _____

B. Treatment Paint Natural to weather Other _____

C. Dimensions: Fascia _____ Rake _____ Soffit (Overhang) _____ Corner boards _____ Frieze _____

Window Casing _____ Door Frame _____ Columns/Posts: Round _____ Square _____

Windows*: Double Hung Casement All Wood Other _____

True Divided Lights(muntins), single pane SDL's (Simulated Divided Lights) Manufacturer _____

Doors* (type and material): TDL SDL Front _____ Rear _____ Side _____

Garage Door(s): Type _____ Material _____

Hardscape materials: Driveways _____ Walkways _____ Walls _____

* Note: Complete door and window schedules are required.

COLORS

Sidewall _____ Clapboard (if applicable) _____ Roof _____
Trim _____ Sash _____ Doors _____
Deck _____ Foundation _____ Fence Black Shutters _____

* Attach manufacturer's color samples if color is not from HDC approval list.

(powder-coated aluminum)

I hereby authorize the agent named above to act on my behalf to make changes in the specifications or the plans contained in this application in order to bring the application into compliance with the HDC guidelines. I hereby agree to abide by and comply with the terms and conditions of this application. I hereby agree that the submission of any revisions to this application will initiate a new sixty-day review period.

Date 2/5/2020 Signature of owner of record _____ Signed under penalties of perjury _____

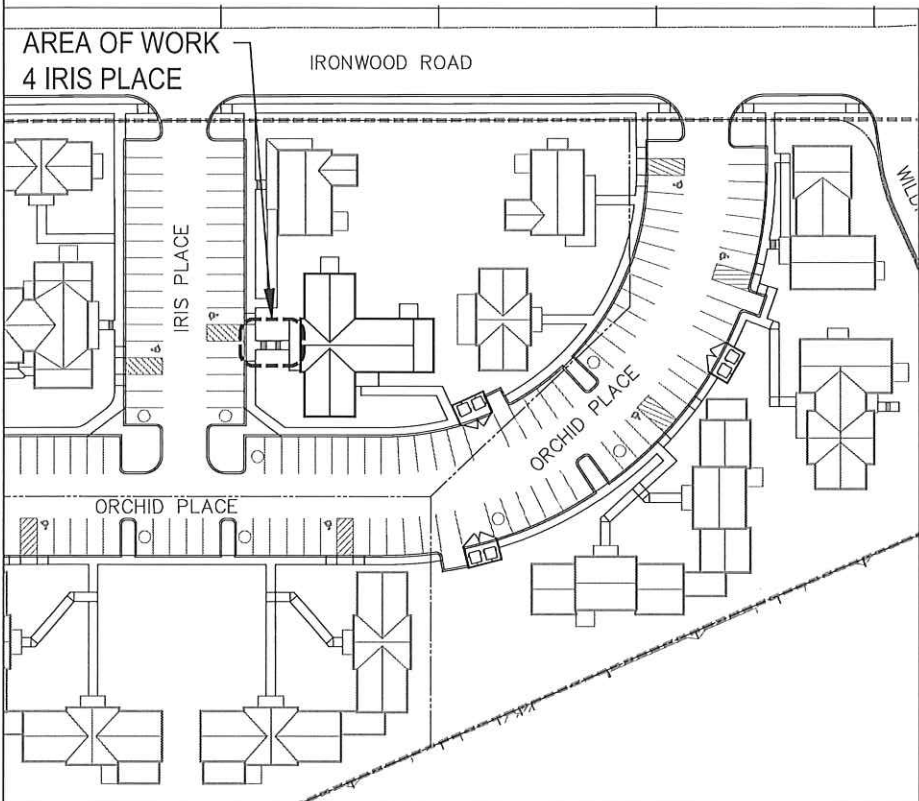

1 SITE PLAN - 4 IRIS PLACE
SCALE: NTS



'DuraLife Nantucket' ALUMINUM RAILING
SCALE: NTS



'DuraLife' FINISH OPTIONS
SCALE: NTS

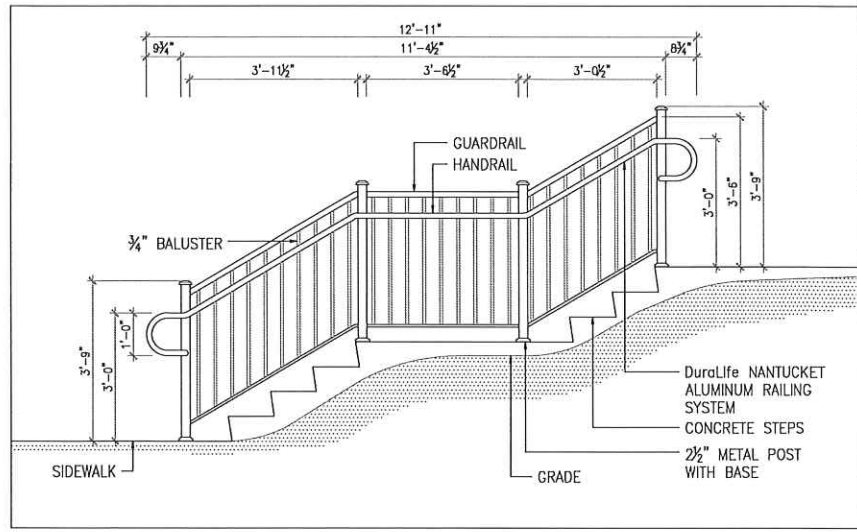

2 EXTERIOR RAILING ELEVATION - 4 IRIS PLACE
SCALE: 3/4" = 1'-0"

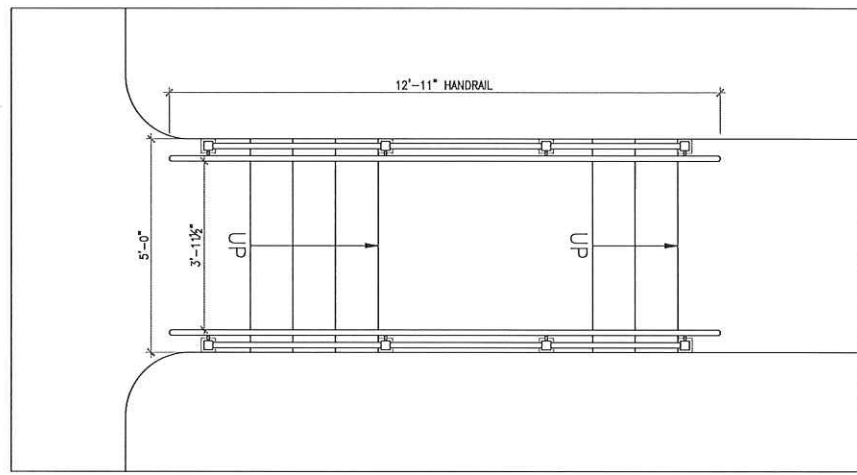

3 EXTERIOR RAILING PLAN - 4 IRIS PLACE
SCALE: 3/4" = 1'-0"

OWNER :
Richmond Great Point Development, LLC
23 Concord Street, Wilmington, MA 01887

ARCHITECT OF RECORD :
K O H ARCHITECTURE PLLC
45-14 251st STREET, SUITE 101
LITTLE HICKS, NY 11362
(718) 225-6400 phone
(718) 225-6404 fax
Dinah Klarner, RA

NO.	DATE	BY	DESCRIPTION

DATE: 08/01/2017
JOB NO. 2009-144
SCALE: AS NOTED

CERTIFICATION AND SEAL
I HEREBY CERTIFY THAT THE PLAN AND SPECIFICATION ARE PREPARED BY ME OR UNDER MY CLOSE SUPERVISION AND THAT I AM A DULY LICENSED ARCHITECT OR ENGINEER UNDER THE LAWS OF THE STATE OF MASSACHUSETTS AS EXERCISED BY HAND AND SEAL.

PROJECT NAME
MEADOWS 2 APARTMENTS

ADDRESS
MAP: 68 PARCEL: 337
4 IRIS PLACE
NANTUCKET, MA

DRAWING TITLE
RAILING HARDSCAPE PLAN

DRAWING NO.
A-1

