

# BUILDING-STRUCTURE INVENTORY FORM

NANTUCKET HISTORIC DISTRICT COMMISSION  
NANTUCKET, MASSACHUSETTS

SURVEY/  
FILM ROLL #: 04D-26-30  
MAP/PARCEL#: 5541-001

Recorded By: AEG Date: 12/13 Organization: HDC

## IDENTIFICATION:

1. STREET NAME & NO.: 21 Pleasant St 2. BUILDING NAME: \_\_\_\_\_

3. OWNERSHIP:  a. public  b. private 4. PRESENT OWNER: Bartlett, Franklin + Arline

5. OWNERSHIP HISTORY: (include owner names, date(s) of ownership, and information source)

built after 1923 and before 1949 - Sanborn maps

6. USE: Original: dwelling Present: dwelling  
 a. seasonal  b. year-round

7. ACCESSIBILITY TO PUBLIC:

Exterior visible from public road:  a. Yes  b. No

Interior accessible, explain: no

8. MAP -- 3 X 2"

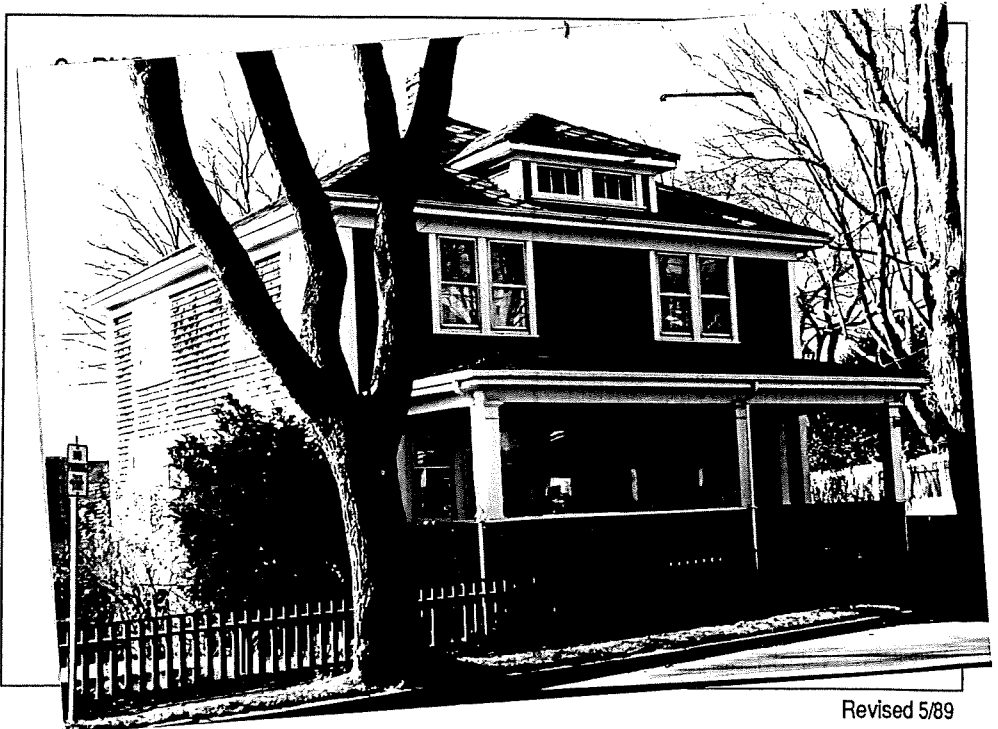
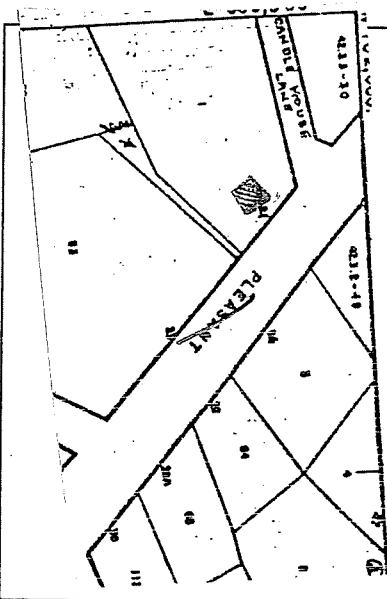

DESCRIPTION:

10. FOUNDATION

- a. brick     b. rubblestone     c. concrete     d. other: \_\_\_\_\_

11. STRUCTURAL SYSTEM

- a. post-and-beam     c. masonry load-bearing walls  
 b. balloon wood frame     d. other: \_\_\_\_\_

12. EXTERIOR WALL MATERIAL: Front Facade:

- a. shingles - weathered     c. brick     e. board and batten  
 b. shingles - painted     d. clapboard     f. flush boarding  
 g. other: \_\_\_\_\_

13. EXTERIOR WALL MATERIAL: Side Elevations:

- a. shingles - weathered     c. brick     e. board and batten  
 b. shingles - painted     d. clapboard     f. flush boarding  
 g. other: \_\_\_\_\_

14. EXTERIOR WALL MATERIAL: Rear Elevation:

- a. shingles - weathered     c. brick     e. board and batten  
 b. shingles - painted     d. clapboard     f. flush boarding  
 g. other: \_\_\_\_\_

15. NUMBER OF STORIES:

- a. 1     c. 1 3/4     e. 2 1/2     g. other: \_\_\_\_\_  
 b. 1 1/2     d. 2     f. 3

16. ROOF SHAPE:

- a. gable     c. hip     e. other: gambrel  
 b. gambrel     d. shed

17. ROOFING MATERIAL:

- a. composition shingle     b. weathered cedar shingle     c. slate

18. ROOF FEATURES:

- a. roof walk     e. balustrade  
 b. dormers on street facade     f. skylight  
 c. dormers on side elevations     g. roof hatch  
 d. dormers on rear elevation     h. cupola  
 i. other: \_\_\_\_\_

19. DORMER ROOF(S):

- a. gable     b. hip     c. shed     d. other: \_\_\_\_\_

20. CHIMNEY MATERIAL:

- a. brick, unpainted     c. brick, parged     e. concrete block  
 b. brick, painted     d. rubblestone     f. metal

21. CHIMNEY POSITION:

- a. center     b. off-center     c. end wall     d. other: \_\_\_\_\_

22. NUMBER OF CHIMNEYS:

- a. one     b. two     c. three     d. other: \_\_\_\_\_

23. CHIMNEY FEATURES:

- a. corbelling     b. chimney pots/owls     c. pilastered

24. FRONT/PRIMARY DOOR LOCATION:

- a. center     b. off-center

25. FRONT/PRIMARY DOOR FRAME FEATURES:

(check several if appropriate)

- a. sidelights
- b. transom
- c. plank frame
- d. flush frame
- e. Federal
- f. fanlight
- g. blind fan
- h. Greek Revival
- i. recessed
- j. other: \_\_\_\_\_

26. NUMBER OF BAYS:

- a. three
- b. four
- c. five
- d. N/A
- e. other: 4

27. WINDOW FRAME TYPE:

- a. flush
- b. plank frame
- c. bull-nose
- d. other: \_\_\_\_\_

28. WINDOW SASH TYPE(S) - FRONT FACADE:

- a. 12/12
- b. 9/9
- c. 6/6
- d. 2/2
- e. casement
- f. other: 1/1, 3/4, 5/6, 6/8

29. PORCH:

- a. front
- b. side
- c. wrap

30. DETAILS:

(check several if appropriate)

- a. corner boards (plain)
- b. corner boards (beaded)
- c. corner board (single)
- d. entry stairs w. balustrade
- e. blinds
- f. watertable
- g. pilasters
- h. trellis
- i. other: \_\_\_\_\_

31. CONDITION:

- a. excellent
- b. good
- c. fair
- d. deteriorated

32. INTEGRITY:

- a. original site
- b. moved if so, when?: \_\_\_\_\_

Major alterations or additions: \_\_\_\_\_  
(with dates if known) \_\_\_\_\_

SIGNIFICANCE:

33. ROLE THE BUILDING PLAYS:

- a. individually significant
- b. contributing
- c. non-contributing

34. DATE OF INITIAL CONSTRUCTION: \_\_\_\_\_ SOURCE: \_\_\_\_\_

ARCHITECT: \_\_\_\_\_

BUILDER: \_\_\_\_\_

35. BUILDING TYPE:

- a. box
- b. additive
- c. gable front
- d. gable ell
- e. side-gabled
- f. other: \_\_\_\_\_

36. STYLE OF ARCHITECTURE:

- a. pre-1750, 2 1/2-story Lean-to
- b. post-1750, 1 3/4-story Lean-to
- c. Typical Nantucket 4-bay
- d. 1 3/4 story, 3-bay
- e. Federal
- f. Greek Revival
- g. Gothic Revival
- h. Italianate
- i. Second Empire
- j. Queen Anne
- k. Colonial Revival
- l. Shingle style
- m. Bungalow
- n. Four Square
- o. other: \_\_\_\_\_

37. HISTORICAL AND ARCHITECTURAL IMPORTANCE: \_\_\_\_\_

38. SOURCES:

- a. Registry of Deeds: \_\_\_\_\_
- b. Assessor's Records: \_\_\_\_\_
- c. Lancaster, The Architecture of Historic Nantucket, page: \_\_\_\_\_
- d. H. C. Forman, Early Nantucket & Its Whaling Houses, page: \_\_\_\_\_
- e. Sanborn Maps, date: \_\_\_\_\_
- f. NHA photos: \_\_\_\_\_
- g. HABS research: \_\_\_\_\_
- h. NHA plaque records: \_\_\_\_\_
- i. other: \_\_\_\_\_

GENERAL SETTING AND ORIENTATION OF BUILDING:

39. LOT SIZE: ; 22A  a. 1/2 acre or less  b. 1/2 acre or more: \_\_\_\_\_

40. APPROXIMATE FRONTAGE: \_\_\_\_\_ feet

41. SETBACK FROM STREET:  a. at sidewalk  c. 20 feet or less  
 b. 10 feet or less  d. other: \_\_\_\_\_

42. ORIENTATION TO STREET ADDRESS:  a. gabled  b. ridge parallel  c. other: \_\_\_\_\_

43. SURROUNDINGS: (check several if appropriate)  
 a. densely built-up  d. residential  
 b. scattered buildings  e. commercial  
 c. open land  f. old historic district

44. RELATED OUTBUILDINGS AND PROPERTY:

See form(s): \_\_\_\_\_

- a. barn
- b. privy
- c. shop
- d. arbor
- e. carriage house
- f. shed
- g. gardens
- h. deck
- i. garage
- j. greenhouse
- k. fence
- l. parking
- m. scallop shanty
- n. landscape features: \_\_\_\_\_
- o. other: \_\_\_\_\_

45. OTHER NOTABLE FEATURES: \_\_\_\_\_

(Building or site including interior features if known) \_\_\_\_\_